

Particular Features:

For medium voltage and heavy door panels.

Chrom plated brass

Parts supplied separately

Note: Bolts and washers are given

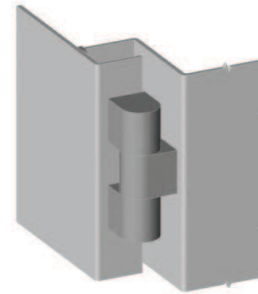
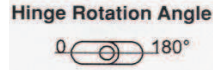

Application:

Electric panels, machinery covers

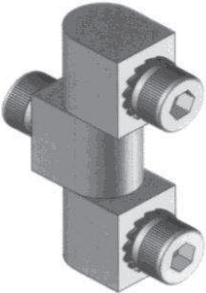
Version	Materials / Finish	Part-No.
	Brass DIN-17672 CuZn39Pb3 chrome plated (CrVI-free)	HS10MD

Dimensions and Hole Preparation

